

GE SERIES

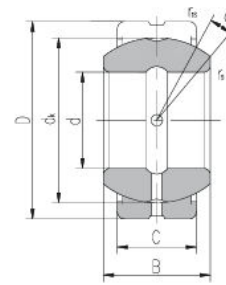

GE...ES 2RS

Specifications

- Sliding Surface: Steel on Steel - MoS₂ treated
- Single Fracture Design
- Relubricatable through annular grooves & oil holes in inner & outer rings (ES – Suffix)

Part #	Dimensions (mm)								Load Ratings kN		Weight LBS
	d	D	B	C	d _k	r _s min	r _{fe} min	α	Dynamic	Static	
GE15ES	15	26	12	9	22	0.3	0.3	8	16	84	.059
GE17ES	17	30	14	10	25	0.3	0.3	10	21	106	.090
GE20ES	20	35	16	12	29	0.3	0.3	9	30	146	.262
GE25ES	25	42	20	16	35.5	0.6	0.6	7	48	240	.262
GE30ES	30	47	22	18	40.7	0.6	0.6	6	62	310	.337
GE35ES	35	55	25	20	47	0.6	1	6	79	399	.513
GE40ES	40	62	28	22	53	0.6	1	7	99	495	.673
GE45ES	45	68	32	25	60	0.6	1	7	127	637	.939
GE50ES	50	75	35	28	66	0.6	1	6	156	780	1.20
GE55ES	55	85	40	32	74	0.6	1	7	200	1000	2.07
GE60ES	60	90	44	36	80	1	1	6	245	1220	2.29